

SALES DRAWING

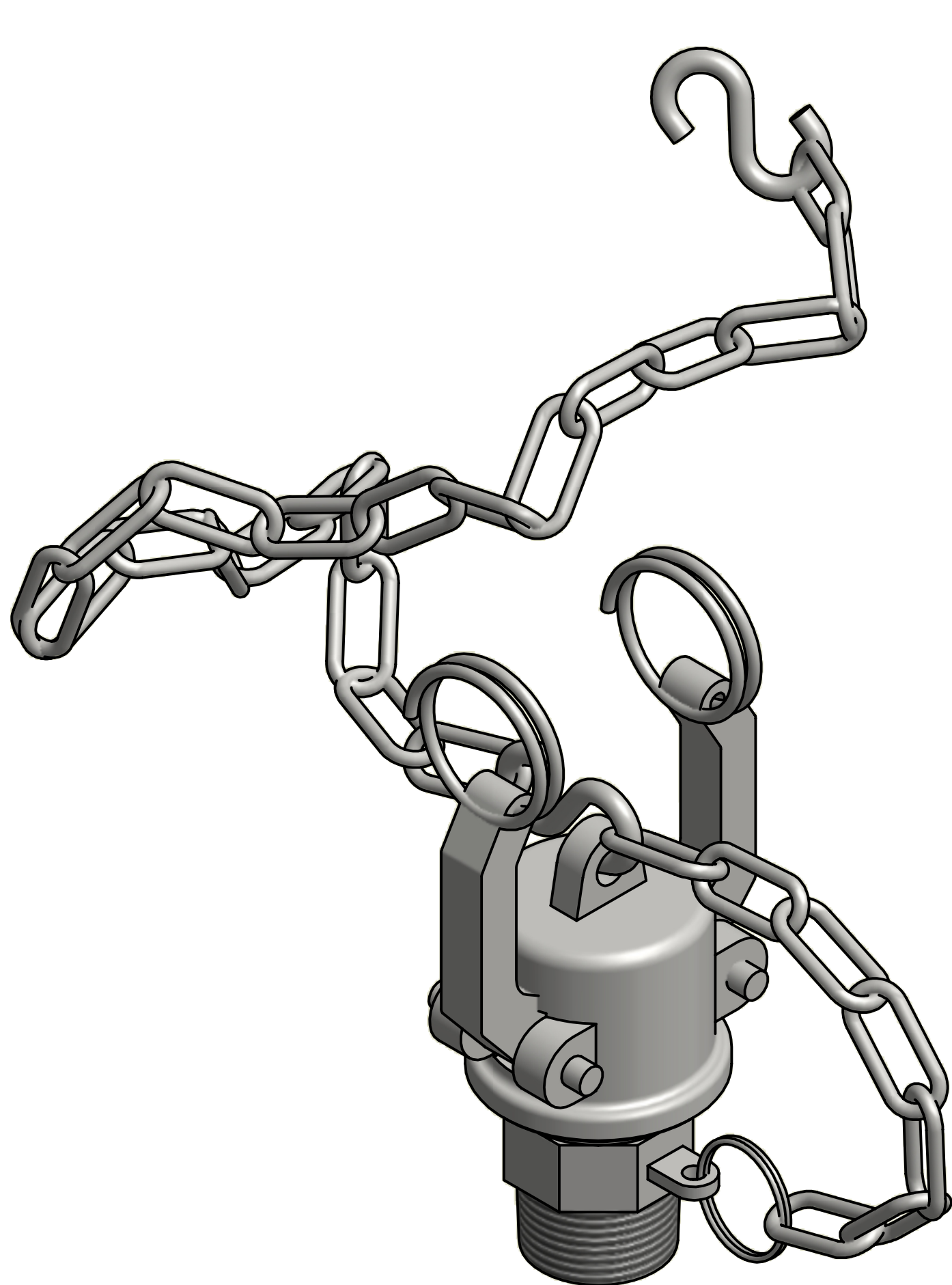

ISOMETRIC VIEW

NOTE:  
GASKET IS BLACK NITRILE.

21 LINKS OF 18-8 SS CHAIN  
APPROXIMATE LENGTH IS 19"

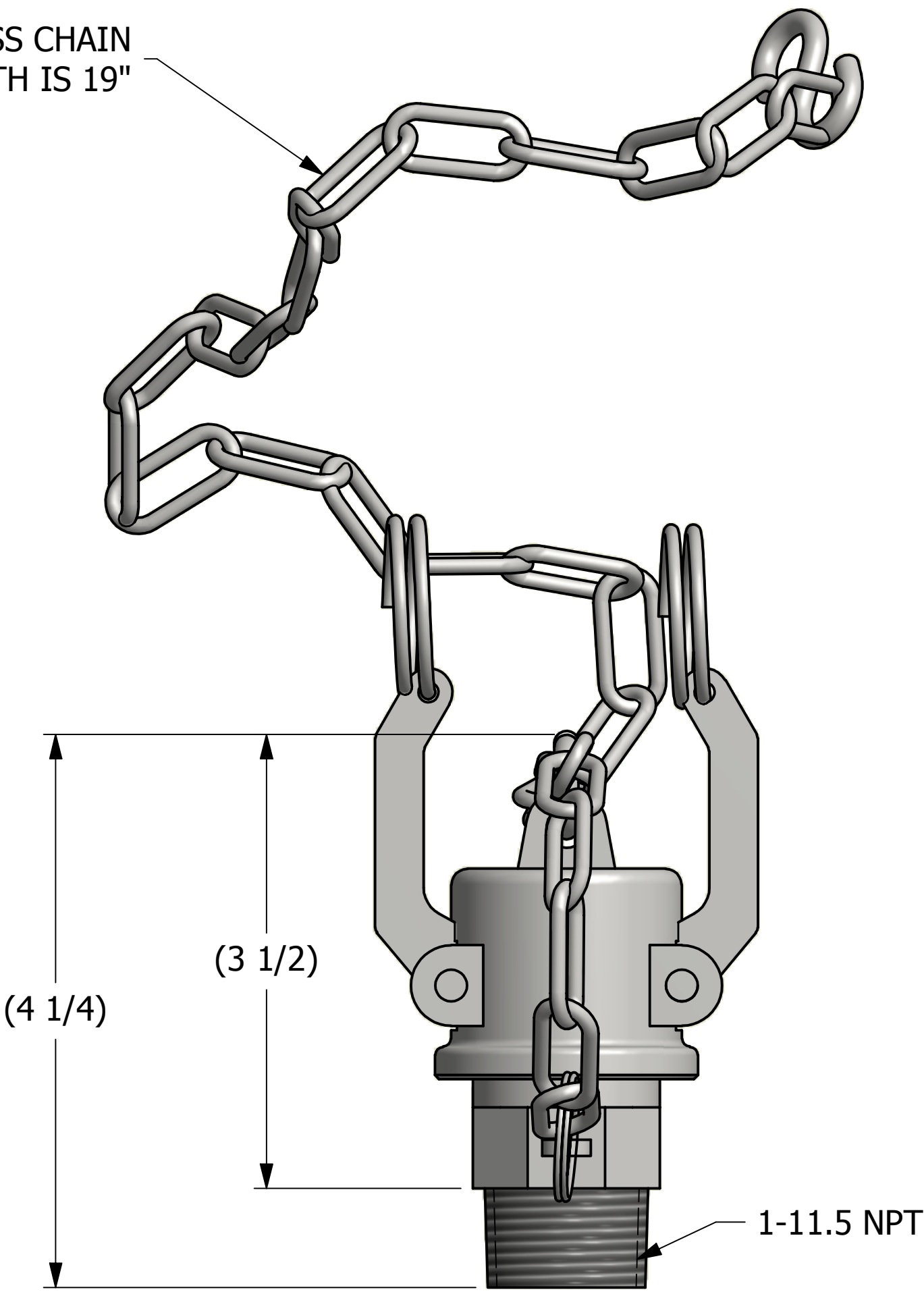

|     |     |         |                                       |
|-----|-----|---------|---------------------------------------|
| C   | JG  | 8-28-15 | UPDATED K1SMPA, UPDATED VIEWS         |
| B   | RJP | 4-9-15  | UPDATED K10SDC1A & K1SMPA             |
| A   | RJP | 6-12-14 | UPDATED K10SDC1A DESIGN & TITLE BLOCK |
| REV | BY  | DATE    | DESCRIPTION                           |

|   |                             |           |
|---|-----------------------------|-----------|
| UNLESS OTHERWISE SPECIFIED<br>DIMENSIONAL TOLERANCES<br>FRACTIONAL: $\pm 1/16$<br>X.XX: $\pm .03$<br>X.XXX: $\pm .015$<br>ANGLE: $\pm 1^\circ$<br>DEBURR ALL SHARP EDGES.<br>ALL MACHINED SURFACES TO<br>HAVE A 125 RMS FINISH UNLESS<br>NOTED OTHERWISE. | DRAWN BY:                   | CHL       |
|   | CHECKED BY:                 | PJG       |
|   | PROTOTYPE BY:               | CHL       |
|   | PROTOTYPE DATE:             | 9/30/2009 |
|   | APPROVED FOR PRODUCTION BY: | PJG       |
|   | PRODUCTION DATE:            | 9/30/2009 |

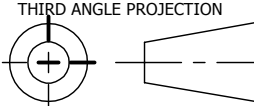

**SALCO PRODUCTS, INC.**

PART NAME:  
**TOP FITTING ASSEMBLY 1" THREAD ON**

MATERIAL: **316 SS**  
PROJECT #: **WAG0733** SHEET #: **1 OF 1** SCALE: **1:1**

DRAWING #: **C27555** PART #: **K10SUMP1A**

SALES DRAWING